

Batik Shadow - February 2020 BoM

Block finishes at 12-1/2 x 14-1/2 with raw edges.

For each block, you will need

One rectangle 8-1/2 x 10-1/2" of any batik

Two rectangles of dark gray each 2-1/2 x 8-1/2" (gray fabric provided)

Two squares of background (BG) fabric each 2-1/2"

Two rectangles of BG fabric each 12-1/2 x 2-1/2"

Construction:

Step 0: Stitch a BG 2-1/2" square to one end of each of the dark gray rectangles, making them each 2-1/2 x 10-1/2"

Step 1: Stitch one of these gray/BG rectangles to the long side of the batik rectangle, with BG at the top. Press the seam to outside or open.

Step 2: Stitch the other gray/BG rectangles to the short side of the batik rectangle, with BG diagonally opposite the other white BG square.

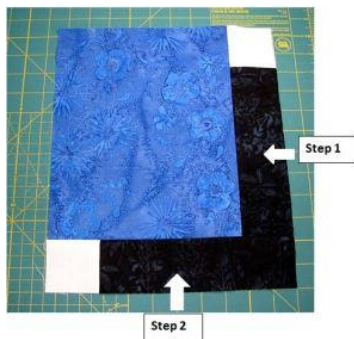

Step 3: Stitch one of the 12-1/2 x 2-1/2" BG rectangles to long side of the batik unit, on the opposite side as the gray (so it would be on the left in the above photo). Press the seam toward the outside or open.

Step 4: Stitch the other 12-1/2 x 2-1/2" BG squares to the top of the batik unit. Press the seam toward the outside or open.

